

Installation User Manual

www.beward.eu

IP VIDEO CAMERA N 13100

1.3 BEWARD H.264
MEGA PIXEL

Night-vision LEDs built-in
16 channel surveillance software included
Built-in multi-zone motion and audio detection



Table of contents

| | |
|--|-----------|
| EUROPE – EU DECLARATION OF CONFORMITY | 2 |
| FEDERAL COMMUNICATION COMMISSION INTERFERENCE STATEMENT | 3 |
| CHAPTER 1. SAFETY INSTRUCTIONS | 4 |
| CHAPTER 2. INTRODUCTION..... | 6 |
| CHAPTER 3. PACKAGE CONTENTS..... | 7 |
| CHAPTER 4. PHYSICAL DESCRIPTION..... | 8 |
| 4.1. FRONT VIEW | 8 |
| 4.2. BOTTOM VIEW..... | 9 |
| CHAPTER 5. BASIC CONNECTION | 10 |
| 5.1. WIRE CONNECTION | 10 |
| 5.2. WIRELESS CONNECTION | 10 |
| CHAPTER 6. APPLICATION | 11 |

Europe – EU Declaration of Conformity

This device complies with the essential requirements of the R&TTE Directive 1999/5/EC. The following test methods have been applied in order to prove presumption of conformity with the essential requirements of the R&TTE Directive 1999/5/EC:

| Clause | Description |
|--|--|
| EN 60950-1: 2001 | Safety of Information Technology Equipment |
| EN 50392: 2004 | Generic standard to demonstrate the compliance of electronic and electrical apparatus with the basic restrictions related to human exposure to electromagnetic fields (0 Hz - 300 GHz) |
| EN 300 328 V1.6.1 (2004-11) | Electromagnetic compatibility and Radio spectrum Matters (ERM); Wideband transmission systems; Data transmission equipment operating in the 2,4 GHz ISM band and using wide band modulation techniques; Harmonized EN covering essential requirements under article 3.2 of the R&TTE Directive |
| EN 301 489-17 V1.2.1 (2002-08) and EN 301 489-1 V1.5.1 (2004-11) | Electromagnetic compatibility and Radio spectrum Matters (ERM); ElectroMagnetic Compatibility (EMC) standard for radio equipment and services; Part 17: Specific conditions for 2,4 GHz wideband transmission systems and 5 GHz high performance RLAN equipment |

This device is a 2.4 GHz wideband transmission system (transceiver), intended for use in all EU member states and EFTA countries, except in France and Italy where restrictive use applies.

In Italy the end-user should apply for a license at the national spectrum authorities in order to obtain authorization to use the device for setting up outdoor radio links and/or for supplying public access to telecommunications and/or network services.

This device may not be used for setting up outdoor radio links in France and in some areas the RF output power may be limited to 10 mW EIRP in the frequency range of 2454 – 2483.5 MHz. For detailed information the end-user should contact the national spectrum authority in France.

Federal Communication Commission Interference Statement

This equipment has been tested and found to comply with the limits for a Class B digital device, pursuant to Part 15 of the FCC Rules. These limits are designed to provide reasonable protection against harmful interference in a residential installation. This equipment generates, uses and can radiate radio frequency energy and, if not installed and used in accordance with the instructions, may cause harmful interference to radio communications. However, there is no guarantee that interference will not occur in a particular installation. If this equipment does cause harmful interference to radio or television reception, which can be determined by turning the equipment off and on, the user is encouraged to try to correct the interference by one of the following measures:

- Reorient or relocate the receiving antenna.
- Increase the separation between the equipment and receiver.
- Connect the equipment into an outlet on a circuit different from that to which the receiver is connected.
- Consult the dealer or an experienced radio/TV technician for help.

This device complies with Part 15 of the FCC Rules. Operation is subject to the following two conditions:

- This device may not cause harmful interference.
- This device must accept any interference received, including interference that may cause undesired operation.

FCC caution

Any changes or modifications not expressly approved by the party responsible for compliance could void the user's authority to operate this equipment.

IEEE 802.11b or 802.11g operation of this product in the U.S.A. is firmware-limited to channels 1 through 11.

Important note

FCC radiation exposure statement: this equipment complies with FCC radiation exposure limits set forth for an uncontrolled environment. This equipment should be installed and operated with minimum distance 20cm between the radiator & your body.

This transmitter must not be co-located or operating in conjunction with any other antenna or transmitter.

Chapter 1. Safety instructions

Before you use this product

This product has been designed with safety in mind. However, the electrical products can cause fires which may lead to serious body injury if not used properly. To avoid such accidents, be sure to heed the following.

Legal caution

Video and audio surveillance can be forbidden by laws that vary from country to country. Check the laws in your local region before using this product for surveillance purposes.

Do not open the housing of the product

Do not try to open the housing or remove the covers which may expose yourself to dangerous voltage or other hazards.

Do not use the accessories not recommend by the manufacturer

Heed the safety precautions

Be sure to follow the general safety precautions and the "Operation Notice."

Operation notice - operating or storage location

Avoid operating or storing the camera in the following locations:

- Extremely hot or cold places
- (Operating temperature: 0 °C to + 50 °C [32 °F to 122°F])
- Exposed to direct sunlight for a long time, or close to heating equipment (e.g., near heaters)
- Close to water (e.g., near a bathtub, kitchen sink, laundry tub)
- Close to sources of strong magnetism
- Close to sources of powerful electromagnetic radiation, such as radios or TV transmitters
- Locations subject to strong vibration or shock

In case of a breakdown

In case of system breakdown, discontinue use and contact your authorized dealer.

In case of abnormal operation

- If the unit emits smoke or an unusual smell
- If water or other foreign objects enter the cabinet

- If you drop the unit or damage the cabinet: 1 Disconnect the cable and the connecting cables. 2 Contact your authorized dealer or the store where you purchased the product.

Transportation

When transporting the camera, repack it as originally packed at the factory or in materials of equal quality.

Ventilation

To prevent heat buildup, do not block air circulation around the device.

Cleaning

Use a soft, dry cloth to clean the external surfaces of the device. Stubborn stains can be removed using a soft cloth dampened with a small quantity of detergent solution, then wipe dry.

Do not use volatile solvents such as alcohol, benzene or thinners as they may damage the surface.

Chapter 2. Introduction

The N13100 is an ultra-compact IP Camera equipped with a high sensitivity progressive scan CMOS sensor, which allows achieving high image quality and superior low-light performance. N13100 also supports 802.11b/g wireless connection and night-vision capability even in complete darkness through 6 high power LEDs. *Picture 2.1.*



Pic. 2.1

Key features:

- Maximum resolution 1280x1024 (SXGA) provides superior image quality
- Simultaneous MPEG-4 (H.264) and motion JPEG video stream
- Excellent image quality up to flexible 15 fps in all resolution for optimum bandwidth use
- Superior low-light performance with 6 night-vision LEDs down to 0 Lux
- Wireless (IEEE 802.11g/b) network connection
- Two-way audio with built-in microphone
- Optimal synchronization of audio and video
- Support live video viewing on windows live messenger (WLM)
- Control panel add-in, i.e. snapshot and image setup
- Supports Mac OS with Safari browser
- Supports iPhone through Safari browser
- Mobile phone streaming live video through 3GPP / ISMA / RTSP
- Mobile phone live Image through 2.5 WAP
- Multi-level password protection for restricting camera access
- Built-in multi-window motion detection (3 detection areas)
- Video buffer makes the streaming smoother
- UPnP and Bonjour for fast and easy Installation
- DDNS support
- 16 channel surveillance software included
- User friendly and multi-lingual UI

Chapter 3. Package contents

Picture 3.1.

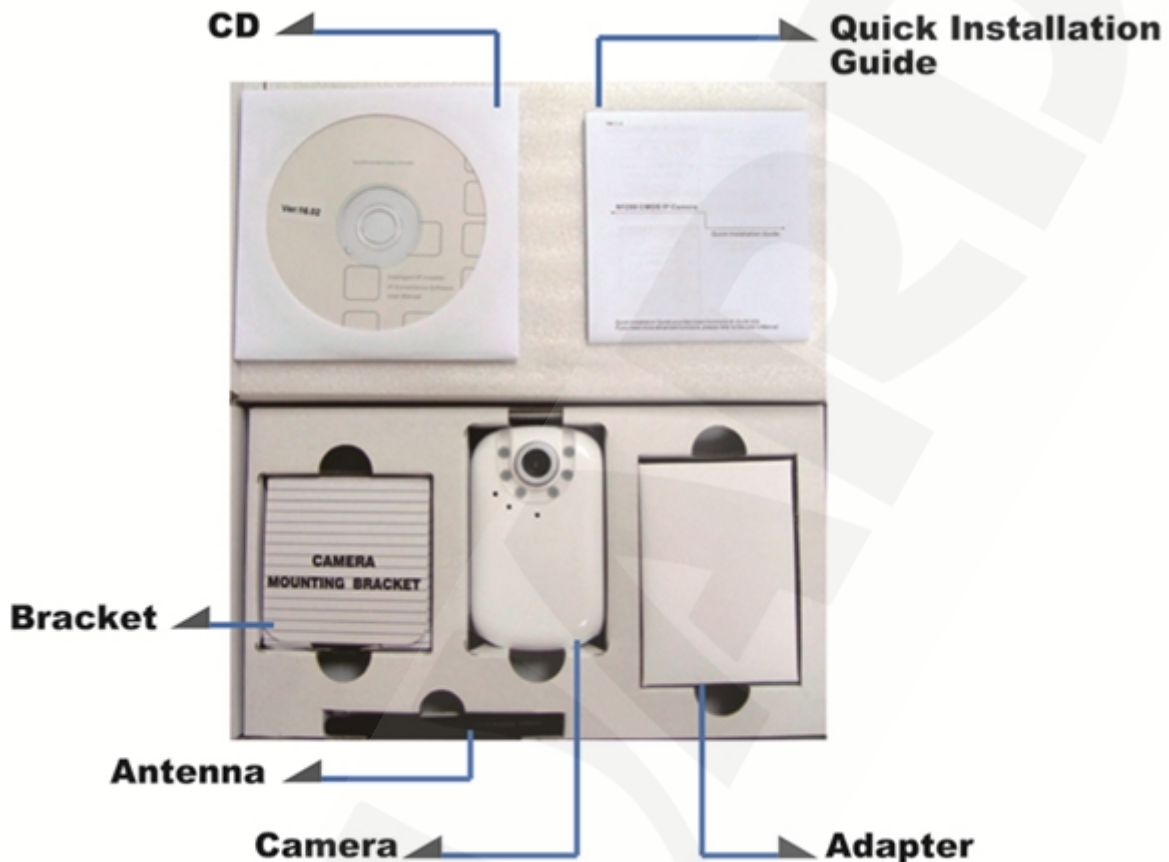

Pic. 3.1

Camera: N13100 IP Camera

Quick installation guide: to provide brief product information and quick installation and wireless setting

Software CD: to provide IP surveillance software, intelligence IP Installer, user manuals, and language packs

Mounting bracket: there are three components including lock ring, brace, and base plate to compose a bracket and three applied screws to fix the base plate to a flat surface (horizontal or vertical)

Antenna: for connection of IEEE 802.11 b / g wireless network

Adaptor: 12V DC, max 12W

Chapter 4. Physical description

4.1. Front view

Picture 4.1.

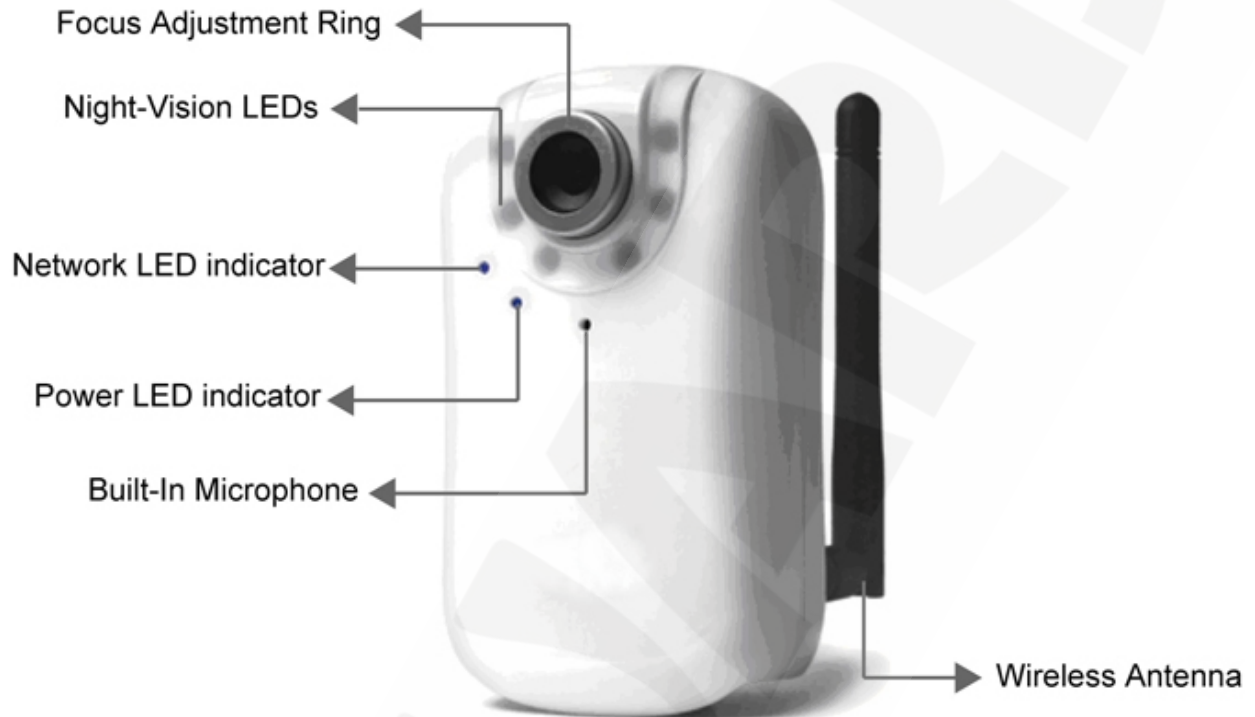

Pic. 4.1

Focus adjustment ring: adjust focus manually to achieve the best image quality

Night-vision white LEDs: LEDs will light up when the environment is too dark

Power LED indicator: power LED will light up after the IP camera completed the boot process

Network LED indicator: network LED will light up after the IP camera connected with network.

Built-in microphone: built-In microphone for two-way audio

Wireless antenna: for connection of IEEE 802.11 b / g wireless network

4.2. Bottom view

Picture 4.2.



Pic. 4.2

Power connector: for connection of 12V DC input

Reset: when the device is empowered, press the reset button to reboot the device, or hold the reset button for 10 seconds to set the device settings back to factory default

Audio out (speaker): to support audio out with earphones or speakers

Network connector: for connection to the Ethernet via RJ-45 standard

Chapter 5. Basic connection

N13100 is for both wire and wireless connection. You can follow the procedure below to connect the IP camera with power and Ethernet for both wire and wireless connection.

5.1. Wire connection

Picture 5.1.

Step 1: connect the power adaptor to IP camera.

Step 2: connect IP camera Ethernet port to your Hub/ Switch / Router.



Pic. 5.1

5.2. Wireless connection

Picture 5.2.

Step 1: connect the power adaptor to IP camera.

Step 2: connect to Wi-Fi

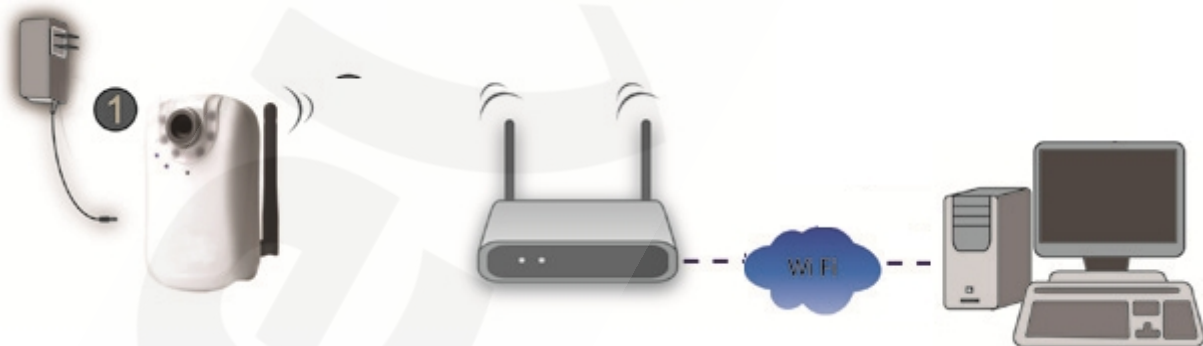

Pic. 5.2

Chapter 6. Application

Picture 6.1.



Pic. 6.1